

JENSEN BEACH GOLF AND COUNTRY CLUB PLAT NO. 2 OF WEST JENSEN, P.U.D./D.R.I.

BEING A REPLAT OF A PORTION OF SECTIONS 17, 18 AND 20, TOWNSHIP 37 SOUTH, RANGE 41 EAST, PLAT NO. 1
ST. LUCIE GARDENS, AS RECORDED IN PLAT BOOK 1, PAGE 35, PUBLIC RECORDS OF ST. LUCIE
(NOW MARTIN) COUNTY, FLORIDA

MAR 19 AM 11:15
MAR 19 1999
CLERK OF CIRCUIT COURT
D.C.

CLERK'S RECORDING CERTIFICATE

I, MARSHA STILLER, CLERK OF THE CIRCUIT COURT OF MARTIN COUNTY, FLORIDA, HEREBY CERTIFY THAT THIS PLAT WAS FILED FOR RECORD IN

PLAT BOOK 14, PAGE 62,
MARTIN COUNTY, FLORIDA, PUBLIC RECORDS THIS
19th DAY OF March, 1999

MARSHA STILLER, CLERK OF THE CIRCUIT COURT
MARTIN COUNTY, FLORIDA.

FILE NUMBER 1356862 BY *Johnny J. Copus*
DEPUTY CLERK

LEGAL DESCRIPTION

PARCEL 1

A PARCEL OF LAND IN SECTIONS 17, 18, AND 20, TOWNSHIP 37 SOUTH, RANGE 41 EAST, MARTIN COUNTY, FLORIDA; BEING PORTIONS OF BLOCK 3 OF SAID SECTION 17, BLOCK 4 OF SAID SECTION 18, AND BLOCK 2 OF SAID SECTION 20, PLAT NO. 1 SAINT LUCIE GARDENS, AS SAME IS RECORDED IN PLAT BOOK 1, PAGE 35, OF THE PUBLIC RECORDS OF ST. LUCIE (NOW MARTIN) COUNTY, FLORIDA; BEING MORE PARTICULARLY DESCRIBED AS FOLLOWS:

COMMENCING AT THE NORTHWEST CORNER OF SAID SECTION 20; THENCE SOUTH 00°08'39" WEST ALONG THE WEST LINE OF SAID SECTION 20, A DISTANCE OF 1250.32 FEET TO THE NORTH RIGHT-OF-WAY LINE OF N.W. JENSEN BEACH BOULEVARD; THENCE SOUTH 89°28'10" EAST, ALONG SAID RIGHT-OF-WAY LINE, A DISTANCE OF 1231.25 FEET; THENCE NORTH 00°31'50" EAST A DISTANCE OF 502.25 FEET TO THE POINT OF BEGINNING; BEING A POINT OF CURVATURE OF A CURVE CONCAVE NORTHERLY, HAVING A RADIUS OF 350.00 FEET AND WHOSE RADIUS POINT BEARS NORTH 04°07'34" WEST; THENCE WESTERLY ALONG THE ARC OF SAID CURVE, THROUGH A CENTRAL ANGLE OF 44°25'10", A DISTANCE OF 271.34 FEET TO THE POINT OF TANGENCY; THENCE NORTH 49°42'24" WEST, A DISTANCE OF 159.45 FEET TO THE POINT OF CURVATURE OF A CURVE CONCAVE WESTERLY AND HAVING A RADIUS OF 450.00 FEET; THENCE NORTHERLY ALONG THE ARC OF SAID CURVE, THROUGH A CENTRAL ANGLE OF 18°54'38", A DISTANCE OF 148.52 FEET TO THE END OF SAID CURVE; THENCE SOUTH 21°22'57" WEST, A DISTANCE OF 22.36 FEET; THENCE NORTH 58°17'03" WEST, A DISTANCE OF 40.49 FEET; THENCE NORTH 34°13'34" WEST, A DISTANCE OF 88.62 FEET TO THE POINT OF CURVATURE OF A CURVE CONCAVE NORTHEASTERLY, HAVING A RADIUS OF 200.00 FEET; THENCE NORTHWESTERLY ALONG THE ARC OF SAID CURVE, THROUGH A CENTRAL ANGLE OF 31°35'39", A DISTANCE OF 110.28 FEET TO THE POINT OF REVERSE CURVATURE OF A CURVE CONCAVE SOUTHWESTERLY, HAVING A RADIUS OF 150.00 FEET; THENCE NORTHWESTERLY ALONG THE ARC OF SAID CURVE, THROUGH A CENTRAL ANGLE OF 54°59'14", A DISTANCE OF 143.96 FEET TO THE POINT OF REVERSE CURVATURE OF A CURVE CONCAVE NORTHEASTERLY, HAVING A RADIUS OF 200.00 FEET; THENCE NORTHWESTERLY ALONG THE ARC OF SAID CURVE, THROUGH A CENTRAL ANGLE OF 64°56'10", A DISTANCE OF 226.67 FEET TO THE POINT OF REVERSE CURVATURE OF A CURVE CONCAVE WESTERLY, HAVING A RADIUS OF 235.00 FEET; THENCE NORTHERLY ALONG THE ARC OF SAID CURVE, THROUGH A CENTRAL ANGLE OF 30°12'13", A DISTANCE OF 123.88 FEET TO THE POINT OF TANGENCY; THENCE NORTH 22°53'12" WEST, A DISTANCE OF 152.98 FEET; THENCE NORTH 67°26'55" WEST, A DISTANCE OF 28.18 FEET; THENCE NORTH 23°52'14" WEST, A DISTANCE OF 22.04 FEET; THENCE NORTH 07°09'17" WEST, A DISTANCE OF 34.90 FEET; THENCE NORTH 14°48'10" WEST, A DISTANCE OF 76.01 FEET TO THE POINT OF CURVATURE OF A CURVE CONCAVE SOUTHWESTERLY, HAVING A RADIUS OF 175.00 FEET AND WHOSE RADIUS POINT BEARS NORTH 67°06'48" EAST; THENCE NORTHWESTERLY ALONG THE ARC OF SAID CURVE, THROUGH A CENTRAL ANGLE OF 29°35'43", A DISTANCE OF 90.39 FEET TO THE END OF SAID CURVE; THENCE NORTH 83°58'48" WEST, A DISTANCE OF 51.72 FEET; THENCE NORTH 57°57'58" WEST, A DISTANCE OF 55.33 FEET; THENCE NORTH 58°37'08" WEST, A DISTANCE OF 46.62 FEET; THENCE NORTH 08°05'05" WEST, A DISTANCE OF 66.91 FEET; THENCE NORTH 37°21'45" WEST, A DISTANCE OF 66.69 FEET; THENCE NORTH 49°11'00" WEST, A DISTANCE OF 69.68 FEET; THENCE NORTH 70°11'14" WEST, A DISTANCE OF 33.77 FEET; THENCE NORTH 12°04'25" WEST, A DISTANCE OF 26.28 FEET; THENCE NORTH 31°29'17" WEST, A DISTANCE OF 32.37 FEET; THENCE NORTH 09°21'29" WEST, A DISTANCE OF 38.42 FEET; THENCE NORTH 37°21'45" WEST, A DISTANCE OF 104.05 FEET TO THE POINT OF CURVATURE OF A CURVE CONCAVE EASTERLY, HAVING A RADIUS OF 225.00 FEET; THENCE NORTHERLY ALONG THE ARC OF SAID CURVE, THROUGH A CENTRAL ANGLE OF 14°42'24", A DISTANCE OF 57.75 FEET TO THE END OF SAID CURVE; THENCE NORTH 46°34'01" WEST, A DISTANCE OF 128.79 FEET; THENCE NORTH 34°31'12" EAST, A DISTANCE OF 137.11 FEET TO A POINT OF CURVATURE OF A CURVE CONCAVE WESTERLY, HAVING A RADIUS OF 80.00 FEET, AND WHOSE RADIUS POINT BEARS SOUTH 62°58'18" WEST; THENCE NORTHERLY ALONG THE ARC OF SAID CURVE, THROUGH A CENTRAL ANGLE OF 40°51'31", A DISTANCE OF 57.05 FEET TO THE END OF SAID CURVE; THENCE NORTH 22°06'47" EAST, A DISTANCE OF 50.00 FEET TO A POINT OF CURVATURE OF A CURVE CONCAVE WESTERLY, HAVING A RADIUS OF 130.00 FEET, AND WHOSE RADIUS POINT BEARS SOUTH 22°06'47" WEST; THENCE SOUTHERLY ALONG THE ARC OF SAID CURVE, THROUGH A CENTRAL ANGLE OF 76°04'31", A DISTANCE OF 172.61 FEET TO THE END OF SAID CURVE; THENCE SOUTH 81°48'42" EAST, A DISTANCE OF 130.00 FEET; THENCE SOUTH 08°11'18" WEST, A DISTANCE OF 63.67 FEET; THENCE SOUTH 37°21'45" EAST, A DISTANCE OF 441.48 FEET TO A POINT ON A CURVE CONCAVE SOUTHWESTERLY, HAVING A RADIUS OF 250.00 FEET AND WHOSE RADIUS POINT BEARS SOUTH 15°48'38" WEST; THENCE SOUTHEASTERLY ALONG THE ARC OF SAID CURVE, THROUGH A CENTRAL ANGLE OF 51°17'35", A DISTANCE OF 223.81 FEET TO THE END OF SAID CURVE; THENCE SOUTH 22°53'12" EAST, A DISTANCE OF 433.43 FEET; THENCE SOUTH 16°21'50" EAST, A DISTANCE OF 247.93 FEET; THENCE SOUTH 51°58'08" WEST, A DISTANCE OF 104.16 FEET TO A POINT ON A CURVE CONCAVE WESTERLY, HAVING A RADIUS OF 200.00 FEET AND WHOSE RADIUS POINT BEARS SOUTH 51°55'06" WEST; THENCE SOUTHERLY ALONG THE ARC OF SAID CURVE, THROUGH A CENTRAL ANGLE OF 35°28'58", A DISTANCE OF 123.74 FEET TO THE POINT OF REVERSE CURVATURE OF A CURVE CONCAVE NORTHEASTERLY, HAVING A RADIUS OF 150.00 FEET; THENCE SOUTHEASTERLY ALONG THE ARC OF SAID CURVE, THROUGH A CENTRAL ANGLE OF 65°59'06", A DISTANCE OF 172.75 FEET TO THE POINT OF REVERSE CURVATURE OF A CURVE CONCAVE SOUTHWESTERLY, HAVING A RADIUS OF 500.00 FEET; THENCE SOUTHEASTERLY ALONG THE ARC OF SAID CURVE, THROUGH A CENTRAL ANGLE OF 18°54'38", A DISTANCE OF 165.03 FEET TO THE POINT OF TANGENCY; THENCE SOUTH 49°42'24" EAST, A DISTANCE OF 159.45 FEET TO THE POINT OF CURVATURE OF A CURVE CONCAVE NORTHERLY, HAVING A RADIUS OF 300.00 FEET; THENCE EASTERLY ALONG THE

ARC OF SAID CURVE, THROUGH A CENTRAL ANGLE OF 44°25'10", A DISTANCE OF 232.58 FEET TO THE END OF SAID CURVE; THENCE SOUTH 04°07'34" EAST, A DISTANCE OF 50.00 FEET TO THE POINT OF BEGINNING.

CONTAINING IN ALL 335,279 SQ. FT. OR 7.697 ACRES, MORE OR LESS

SUBJECT TO EASEMENTS, RESTRICTIONS, RESERVATIONS AND RIGHTS-OF-WAY OF RECORD.

PARCEL 2

A PARCEL OF LAND IN SECTIONS 17 AND 20, TOWNSHIP 37 SOUTH, RANGE 41 EAST, MARTIN COUNTY, FLORIDA; BEING PORTIONS OF BLOCKS 1, 2, 3, AND 4 OF SAID SECTION 17, AND BLOCKS 1 AND 2 OF SAID SECTION 20, PLAT NO. 1 SAINT LUCIE GARDENS, AS SAME IS RECORDED IN PLAT BOOK 1, PAGE 35, OF THE PUBLIC RECORDS OF ST. LUCIE (NOW MARTIN) COUNTY, FLORIDA; BEING MORE PARTICULARLY DESCRIBED AS FOLLOWS:

COMMENCING AT THE NORTHWEST CORNER OF SAID SECTION 20; THENCE SOUTH 00°08'39" WEST ALONG THE WEST LINE OF SAID SECTION 20, A DISTANCE OF 1250.32 FEET TO THE NORTH RIGHT-OF-WAY LINE OF N.W. JENSEN BEACH BOULEVARD; THENCE SOUTH 89°28'10" EAST, ALONG SAID RIGHT-OF-WAY LINE, A DISTANCE OF 1169.77 FEET; THENCE NORTH 00°31'50" EAST A DISTANCE OF 1592.42 FEET TO THE POINT OF BEGINNING; THENCE NORTH 19°04'02" WEST, A DISTANCE OF 60.02 FEET; THENCE NORTH 69°20'03" EAST, A DISTANCE OF 61.07 FEET TO THE POINT OF CURVATURE OF A CURVE CONCAVE SOUTHERLY, HAVING A RADIUS OF 200.00 FEET; THENCE EASTERLY ALONG THE ARC OF SAID CURVE, THROUGH A CENTRAL ANGLE OF 32°00'27", A DISTANCE OF 111.73 FEET TO THE POINT OF REVERSE CURVATURE OF A CURVE CONCAVE NORTHERLY, HAVING A RADIUS OF 200.00 FEET; THENCE EASTERLY ALONG THE ARC OF SAID CURVE, THROUGH A CENTRAL ANGLE OF 42°29'39", A DISTANCE OF 148.33 FEET TO THE POINT OF TANGENCY; THENCE NORTH 58°50'52" EAST, A DISTANCE OF 217.73 FEET; THENCE NORTH 31°09'08" WEST, A DISTANCE OF 125.00 FEET; THENCE NORTH 58°50'52" EAST, A DISTANCE OF 86.95 FEET TO THE POINT OF CURVATURE OF A CURVE CONCAVE SOUTHERLY, HAVING A RADIUS OF 685.00 FEET; THENCE EASTERLY ALONG THE ARC OF SAID CURVE, THROUGH A CENTRAL ANGLE OF 33°32'42", A DISTANCE OF 401.05 FEET TO THE POINT OF TANGENCY; THENCE SOUTH 87°36'26" EAST, A DISTANCE OF 246.85 FEET TO THE POINT OF CURVATURE OF A CURVE CONCAVE NORTHERLY, HAVING A RADIUS OF 815.00 FEET; THENCE EASTERLY ALONG THE ARC OF SAID CURVE, THROUGH A CENTRAL ANGLE OF 22°57'35", A DISTANCE OF 326.59 FEET TO THE POINT OF COMPOUND CURVATURE OF A CURVE CONCAVE NORTHWESTERLY, HAVING A RADIUS OF 195.00 FEET; THENCE NORTHEASTERLY ALONG THE ARC OF SAID CURVE, THROUGH A CENTRAL ANGLE OF 51°28'02", A DISTANCE OF 175.05 FEET TO THE END OF SAID CURVE; THENCE NORTH 07°43'14" EAST, ALONG A NON-TANGENT LINE, A DISTANCE OF 286.41 FEET TO A POINT ON A CURVE CONCAVE NORTHEASTERLY, HAVING A RADIUS OF 460.00 FEET AND WHOSE RADIUS POINT BEARS NORTH 48°04'40" EAST; THENCE NORTHWESTERLY ALONG THE ARC OF SAID CURVE, THROUGH A CENTRAL ANGLE OF 34°33'59", A DISTANCE OF 277.52 FEET TO THE POINT OF TANGENCY; THENCE NORTH 07°21'20" WEST, A DISTANCE OF 195.94 FEET; TO THE POINT OF CURVATURE OF A CURVE CONCAVE WESTERLY, HAVING A RADIUS OF 350.00 FEET; THENCE NORTHERLY ALONG THE ARC OF SAID CURVE, THROUGH A CENTRAL ANGLE OF 10°05'49", A DISTANCE OF 61.68 FEET TO THE POINT OF TANGENCY; THENCE NORTH 17°27'09" WEST, A DISTANCE OF 110.56 FEET; THENCE NORTH 76°34'16" WEST, A DISTANCE OF 308.21 FEET; THENCE NORTH 29°13'31" WEST, A DISTANCE OF 1126.40 FEET; THENCE NORTH 61°49'21" EAST, A DISTANCE OF 236.67 FEET; THENCE NORTH 25°14'32" EAST, A DISTANCE OF 60.00 FEET TO THE POINT OF CURVATURE OF A CURVE CONCAVE NORTHERLY, HAVING A RADIUS OF 170.00 FEET AND WHOSE RADIUS POINT BEARS NORTH 25°14'32" EAST; THENCE EASTERLY ALONG THE ARC OF SAID CURVE, THROUGH A CENTRAL ANGLE OF 04°35'13", A DISTANCE OF 13.61 FEET TO THE POINT OF COMPOUND CURVATURE WITH A CURVE CONCAVE NORTHWESTERLY, HAVING A RADIUS OF 25.00 FEET; THENCE NORTHERLY, ALONG THE ARC OF SAID CURVE, THROUGH A CENTRAL ANGLE OF 85°08'49", A DISTANCE OF 37.15 FEET TO THE POINT OF REVERSE CURVATURE WITH A CURVE CONCAVE EASTERLY, HAVING A RADIUS OF 75.00 FEET; THENCE NORTHERLY ALONG THE ARC OF SAID CURVE THROUGH A CENTRAL ANGLE OF 52°18'40", A DISTANCE OF 68.48 FEET TO THE END OF SAID CURVE; THENCE NORTH 19°26'07" EAST, A DISTANCE OF 656.44 FEET; THENCE SOUTH 72°43'21" EAST, A DISTANCE OF 55.30 FEET; THENCE SOUTH 76°31'12" EAST, A DISTANCE OF 35.49 FEET; THENCE SOUTH 85°40'35" EAST, A DISTANCE OF 53.73 FEET; THENCE SOUTH 63°54'18" EAST, A DISTANCE OF 42.25 FEET; THENCE SOUTH 84°37'07" EAST, A DISTANCE OF 57.58 FEET; THENCE SOUTH 55°31'55" EAST, A DISTANCE OF 204.91 FEET; THENCE SOUTH 07°30'06" EAST, A DISTANCE OF 37.73 FEET; THENCE SOUTH 06°45'44" EAST, A DISTANCE OF 44.92 FEET; THENCE SOUTH 12°25'57" EAST, A DISTANCE OF 37.19 FEET; THENCE SOUTH 12°18'54" EAST, A DISTANCE OF 47.75 FEET; THENCE SOUTH 04°37'13" EAST, A DISTANCE OF 27.11 FEET; THENCE SOUTH 13°33'36" WEST, A DISTANCE OF 29.72 FEET; THENCE SOUTH 46°12'02" WEST, A DISTANCE OF 40.50 FEET; THENCE SOUTH 54°21'33" WEST, A DISTANCE OF 39.97 FEET; THENCE SOUTH 56°10'01" WEST, A DISTANCE OF 43.60 FEET; THENCE SOUTH 60°28'14" WEST, A DISTANCE OF 50.00 FEET; THENCE SOUTH 79°06'10" WEST, A DISTANCE OF 31.88 FEET; THENCE NORTH 77°36'10" WEST, A DISTANCE OF 28.10 FEET; THENCE SOUTH 05°56'44" WEST, A DISTANCE OF 111.17 FEET TO THE POINT OF CURVATURE OF A CURVE CONCAVE NORTHEASTERLY, HAVING A RADIUS OF 25.00 FEET; THENCE SOUTHEASTERLY ALONG THE ARC OF SAID CURVE, THROUGH A CENTRAL ANGLE OF 90°00'00", A DISTANCE OF 39.27 FEET TO THE POINT OF TANGENCY; THENCE SOUTH 84°03'16" EAST, A DISTANCE OF 45.45 FEET TO THE POINT OF CURVATURE OF A CURVE CONCAVE SOUTHWESTERLY, HAVING A RADIUS OF 150.00 FEET; THENCE SOUTHEASTERLY ALONG THE ARC OF SAID CURVE, THROUGH A CENTRAL ANGLE

OF 54°19'01", A DISTANCE OF 142.20 FEET TO THE POINT OF TANGENCY; THENCE SOUTH 29°44'15" EAST, A DISTANCE OF 59.48 FEET TO THE POINT OF CURVATURE OF A CURVE CONCAVE WESTERLY, HAVING A RADIUS OF 150.00 FEET; THENCE SOUTHERLY ALONG THE ARC OF SAID CURVE, THROUGH A CENTRAL ANGLE OF 49°58'20", A DISTANCE OF 130.83 FEET TO THE POINT OF REVERSE CURVATURE OF A CURVE CONCAVE EASTERLY, HAVING A RADIUS OF 100.00 FEET; THENCE SOUTHERLY ALONG THE ARC OF SAID CURVE, THROUGH A CENTRAL ANGLE OF 22°40'06", A DISTANCE OF 39.56 FEET TO THE END OF SAID CURVE; THENCE SOUTH 87°33'59" WEST, A DISTANCE OF 180.00 FEET TO A POINT ON A CURVE CONCAVE EASTERLY, HAVING A RADIUS OF 280.00 FEET, AND WHOSE RADIUS POINT BEARS NORTH 87°33'59" EAST; THENCE NORTHERLY ALONG THE ARC OF SAID CURVE, THROUGH A CENTRAL ANGLE OF 19°40'53", A DISTANCE OF 96.18 FEET TO THE END OF SAID CURVE; THENCE NORTH 29°44'15" WEST, A DISTANCE OF 30.96 FEET; THENCE NORTH 84°03'16" WEST, A DISTANCE OF 360.97 FEET TO A POINT ON A CURVE CONCAVE SOUTHWESTERLY, HAVING A RADIUS OF 400.00 FEET AND WHOSE RADIUS POINT BEARS SOUTH 36°23'46" WEST; THENCE SOUTHEASTERLY ALONG THE ARC OF SAID CURVE, THROUGH A CENTRAL ANGLE OF 34°53'39", A DISTANCE OF 243.61 FEET TO THE POINT OF TANGENCY; THENCE SOUTH 18°42'35" EAST, A DISTANCE OF 224.86 FEET TO THE POINT OF CURVATURE OF A CURVE CONCAVE NORTHEASTERLY, HAVING A RADIUS OF 357.25 FEET; THENCE SOUTHEASTERLY ALONG THE ARC OF SAID CURVE, THROUGH A CENTRAL ANGLE OF 24°33'57", A DISTANCE OF 153.17 FEET TO THE POINT OF REVERSE CURVATURE OF A CURVE CONCAVE SOUTHWESTERLY, HAVING A RADIUS OF 280.00 FEET; THENCE SOUTHEASTERLY ALONG THE ARC OF SAID CURVE, THROUGH A CENTRAL ANGLE OF 25°05'59", A DISTANCE OF 113.97 FEET TO THE POINT OF TANGENCY; THENCE SOUTH 18°09'33" EAST, A DISTANCE OF 107.88 FEET TO THE POINT OF CURVATURE OF A CURVE CONCAVE NORTHEASTERLY, HAVING A RADIUS OF 370.00 FEET; THENCE SOUTHEASTERLY ALONG THE ARC OF SAID CURVE, THROUGH A CENTRAL ANGLE OF 09°08'20", A DISTANCE OF 59.02 FEET TO THE END OF SAID CURVE; THENCE NORTH 82°38'40" EAST, A DISTANCE OF 177.25 FEET; THENCE SOUTH 07°21'20" EAST, A DISTANCE OF 688.37 FEET; THENCE SOUTH 82°38'40" WEST, A DISTANCE OF 130.00 FEET TO A POINT ON A CURVE CONCAVE NORTHEASTERLY, HAVING A RADIUS OF 400.00 FEET AND WHOSE RADIUS POINT BEARS NORTH 82°38'40" EAST; THENCE SOUTHEASTERLY ALONG THE ARC OF SAID CURVE, THROUGH A CENTRAL ANGLE OF 41°58'10", A DISTANCE OF 293.00 FEET TO THE POINT OF REVERSE CURVATURE OF A CURVE CONCAVE WESTERLY, HAVING A RADIUS OF 260.00 FEET; THENCE SOUTHERLY ALONG THE ARC OF SAID CURVE, THROUGH A CENTRAL ANGLE OF 67°19'27", A DISTANCE OF 305.51 FEET TO THE POINT OF TANGENCY; THENCE SOUTH 17°59'57" WEST, A DISTANCE OF 70.89 FEET; THENCE NORTH 75°26'53" EAST, A DISTANCE OF 424.82 FEET TO THE WEST RIGHT-OF-WAY OF A 50 FOOT WIDE CITY OF PORT ST. LUCIE RIGHT-OF-WAY; THENCE SOUTH 34°23'37" EAST, ALONG SAID RIGHT-OF-WAY, A DISTANCE OF 479.10 FEET; THENCE SOUTH 62°59'43" WEST, DEPARTING SAID RIGHT-OF-WAY LINE, A DISTANCE OF 359.50 FEET; THENCE NORTH 53°18'20" WEST, A DISTANCE OF 92.70 FEET; THENCE NORTH 36°41'40" EAST, A DISTANCE OF 64.83 FEET; THENCE NORTH 53°18'20" WEST, A DISTANCE OF 135.00 FEET; THENCE SOUTH 36°41'40" WEST, A DISTANCE OF 123.86 FEET; THENCE SOUTH 14°47'43" EAST, A DISTANCE OF 23.83 FEET TO THE POINT OF CURVATURE OF A CURVE CONCAVE EASTERLY, HAVING A RADIUS OF 50.00 FEET, AND WHOSE RADIUS POINT BEARS SOUTH 14°47'43" EAST; THENCE WESTERLY AND SOUTHERLY, ALONG THE ARC OF SAID CURVE, THROUGH A CENTRAL ANGLE OF 128°30'37", A DISTANCE OF 112.15 FEET TO THE POINT OF TANGENCY; THENCE SOUTH 53°18'20" EAST, A DISTANCE OF 242.53 FEET TO THE POINT OF CURVATURE OF A CURVE CONCAVE WESTERLY, HAVING A RADIUS OF 25.00 FEET; THENCE SOUTHERLY ALONG THE ARC OF SAID CURVE, THROUGH A CENTRAL ANGLE OF 81°09'00", A DISTANCE OF 35.41 FEET TO THE END OF SAID CURVE; THENCE SOUTH 53°59'25" EAST, A DISTANCE OF 50.62 FEET; THENCE SOUTH 63°48'12" EAST, A DISTANCE OF 133.96 FEET TO A POINT ON A CURVE CONCAVE EASTERLY, HAVING A RADIUS OF 180.00 FEET, AND WHOSE RADIUS POINT BEARS SOUTH 64°26'45" EAST; THENCE SOUTHERLY ALONG THE ARC OF SAID CURVE, THROUGH A CENTRAL ANGLE OF 46°28'20", A DISTANCE OF 146.00 FEET TO THE POINT OF TANGENCY; THENCE SOUTH 20°55'05" EAST, A DISTANCE OF 207.31 FEET; THENCE SOUTH 69°04'55" WEST, A DISTANCE OF 115.00 FEET; THENCE SOUTH 67°02'45" WEST, A DISTANCE OF 50.03 FEET; THENCE SOUTH 69°04'55" WEST, A DISTANCE OF 115.00 FEET; THENCE SOUTH 20°55'05" EAST, A DISTANCE OF 65.00 FEET; THENCE SOUTH 69°04'55" WEST, A DISTANCE OF 66.26 FEET TO THE POINT OF CURVATURE OF A CURVE CONCAVE SOUTHEASTERLY, HAVING A RADIUS OF 40.00 FEET; THENCE SOUTHWESTERLY ALONG THE ARC OF SAID CURVE, THROUGH A CENTRAL ANGLE OF 89°08'33", A DISTANCE OF 62.23 FEET TO THE POINT OF REVERSE CURVATURE OF A CURVE CONCAVE NORTHERLY, HAVING A RADIUS OF 175.00 FEET; THENCE WESTERLY ALONG THE ARC OF SAID CURVE, THROUGH A CENTRAL ANGLE OF 144°58'28", A DISTANCE OF 442.80 TO THE END OF SAID CURVE; THENCE SOUTH 12°02'24" WEST, A DISTANCE OF 43.18 FEET; THENCE SOUTH 29°04'34" WEST, A DISTANCE OF 30.33 FEET; THENCE SOUTH 77°42'13" WEST, A DISTANCE OF 143.96 FEET; THENCE NORTH 38°15'37" WEST, A DISTANCE OF 1486.73 FEET TO THE POINT OF CURVATURE OF A CURVE CONCAVE NORTHERLY, HAVING A RADIUS OF 280.00 FEET, AND WHOSE RADIUS POINT BEARS NORTH 31°09'08" WEST; THENCE WESTERLY ALONG THE ARC OF SAID CURVE, THROUGH A CENTRAL ANGLE OF 42°29'39", A DISTANCE OF 192.83 FEET TO THE POINT OF REVERSE CURVATURE WITH A CURVE CONCAVE SOUTHERLY, HAVING A RADIUS OF 140.00 FEET; THENCE WESTERLY ALONG THE ARC OF SAID CURVE, THROUGH A CENTRAL ANGLE OF 32°00'27", A DISTANCE OF 78.21 FEET TO THE POINT OF TANGENCY; THENCE SOUTH 69°20'03" WEST, A DISTANCE OF 62.75 FEET TO THE POINT OF BEGINNING.

CONTAINING IN ALL 3,392,139 SQ. FT. OR 77.873 ACRES, MORE OR LESS.

SUBJECT TO EASEMENTS, RESTRICTIONS, RESERVATIONS AND RIGHTS-OF-WAY OF RECORD.

17-37-41-006-000-0000.0
SUBDIVISION PARCEL CONTROL NO.

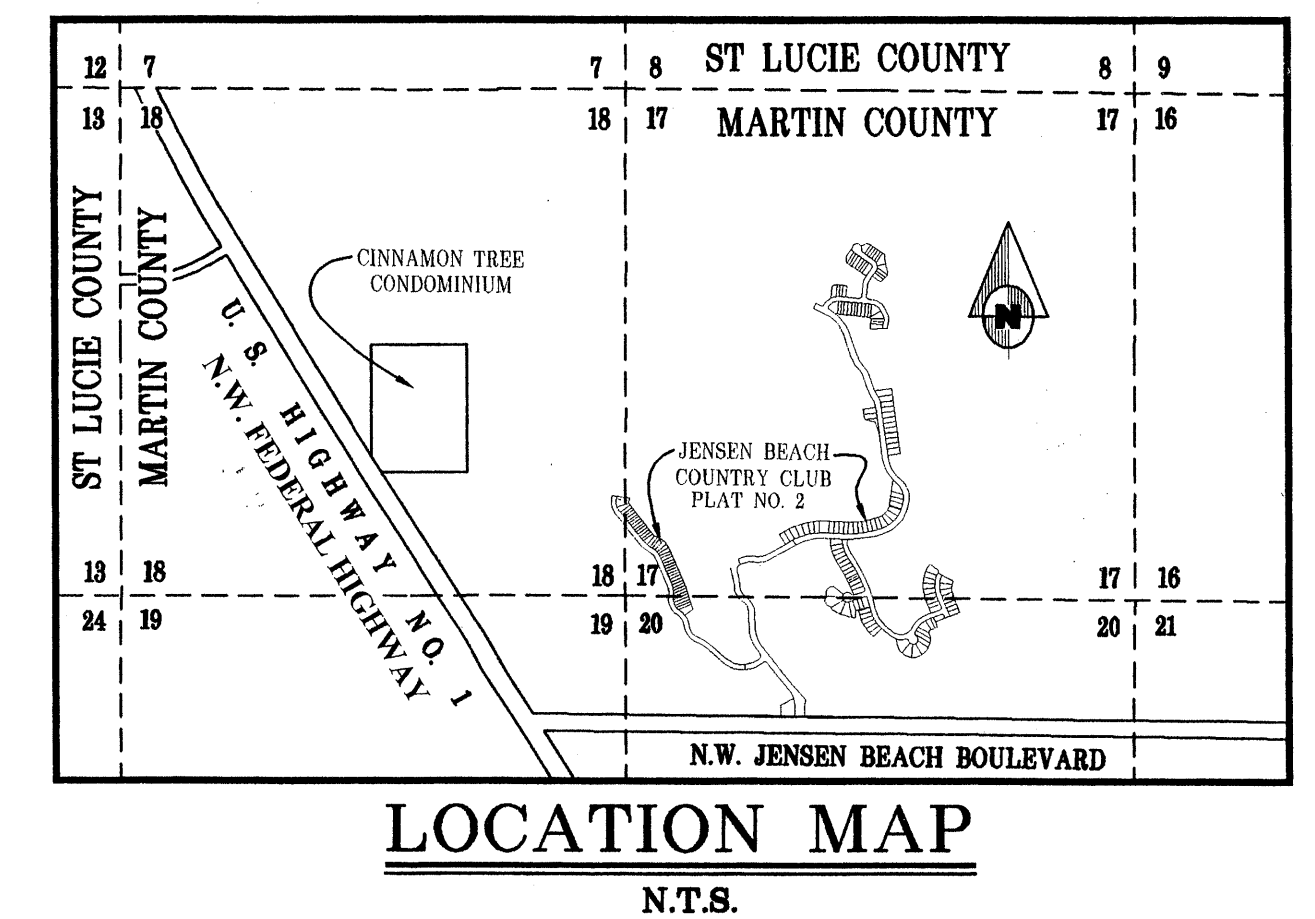
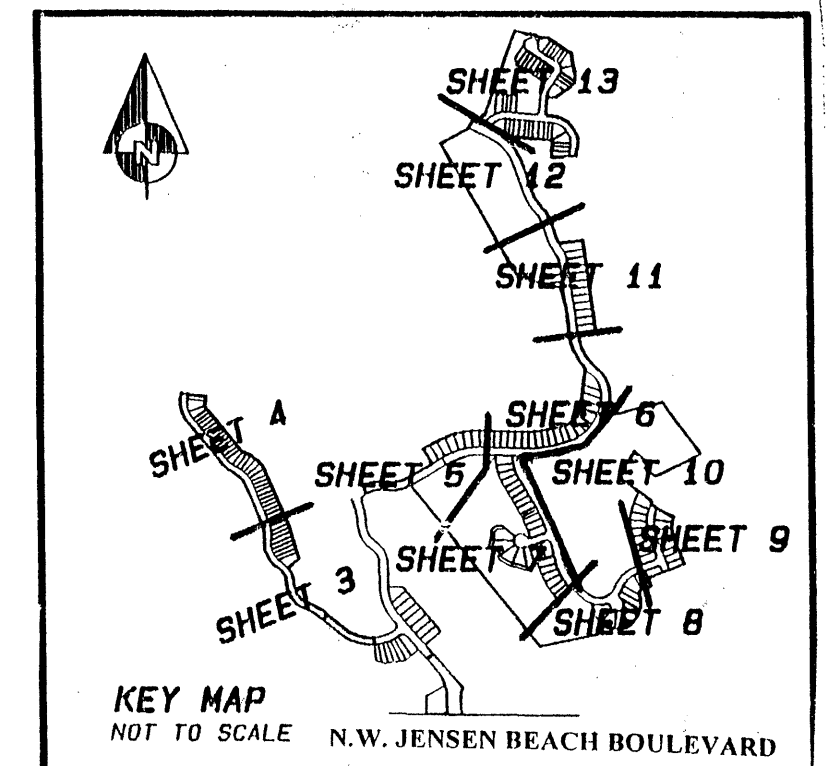

SHEET 1 OF 13

METES & BOUNDS, INC.
Land Surveyors-Planners
5050 10th Avenue North Suite B
Lake Worth FL 33463-2602
Phone: 561-965-8941 Fax: 561-965-8963